

STUDENT APARTMENT **SAN FRANCISCO**

Rexidence Fillmore Center



Rexidence Fillmore Center is a large and luxurious apartment complex located in the heart of San Francisco. Just a 15-minute bus ride from the Kaplan International location, the Fillmore District is the perfect place for international students. Fillmore is one of San Francisco's liveliest and most historic neighbourhoods. Famous for its jazz, and on the edge of Japantown, there are great bars, restaurants, cafes and clubs. Rexidence Fillmore Center is also only one block from a large supermarket, and other great shopping.

Spacious 2 bedroom / 2 bathroom apartments have fully equipped kitchens, and a separate living room/dining room area. Each apartment has a dining table, flat screen television with cable, and free high speed wireless internet. Residents have access to laundry on designated floors, large communal grounds, including barbecue areas, and they can also use the free shuttle bus into downtown. There is a full service fitness center with swimming pool within the complex, for which residents receive discounted membership rates.



Rexidence Fillmore Center



Location of Kaplan's San Francisco school and Rexidence Fillmore Center

Rexidence Fillmore Center
1475 Fillmore Street
San Francisco
CA 94115
USA

STUDENT APARTMENT REXIDENCE FILLMORE
SAN FRANCISCO



Bedroom



Bathroom

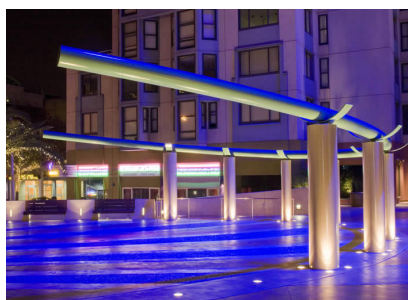

Kitchen



Courtyard



Living room



Living room

Accommodation details

Type of accommodation

Shared apartments with twin rooms, two bathrooms and fully equipped kitchen. The twin room can be booked as a single. Each apartment has a flat screen TV with cable, two sofas, dining table and chairs, ringing board and iron.

Meals

No meal plan is included in the offer.

Kitchen/cooking facilities

The private kitchen includes refrigerator, microwave, dishwasher, garbage disposal, utensils and dishware.

Rooms

Each room has 2 beds and 2 desks.

Bathrooms

Each apartment has 2 private bathrooms with tub/shower combination.

Bed linens and towels

Bed linens and towels are provided.

Internet

Free wireless internet is available in each unit.

Utilities

All apartments have central heating. Electricity, gas and water are included in the weekly accommodation fees. The electrical current is 110/ 120 Volts. Students from some countries will require a transformer or adapter.

Laundry

Laundry facilities are available on designated floors. Reloadable cards can be purchased and reloaded online. Cost per load is \$1.75 for wash and \$1.25 dry. Wash and fold and dry cleaning pickup and delivery service are also available.

Security and keys

Security staff are available 24 hours per day. The complex requires electronic key card to access, and each apartments are accessible by key.

Noise and restrictions

Students are asked to be respectful of others in the complex. Noise levels should be kept to a reasonable level. No smoking is permitted inside the apartment.

Availability

Year-round stays are subject to availability at the time of request. Advanced notice is highly recommended for stays during peak tourist season from July to August.

Visitors

Students are allowed to have visitors at any time.

Deposit

A deposit of \$500 needs to be paid by cash, personal check or wire transfer upon check-in. The deposit will be refunded upon check-out provided there are no damages or loss.

Minimum age

18 years.

Check-in and Check-out

Check-in time is Saturday at 2:00pm. Check-out time is Saturday between 10:00am and 11:00am.

Different room types are available and the pictures are examples only. Information is subject to change. Published October 2014. Revised February 2015.